

ASMC Shell Milling Cutters

Tool Ordering Number	Dimensions					Use with			RPM Max
	ØD	L	ØD1	Key Width	Z	Screw	Key	Inserts	
ASMC-2.00/3	2.00	2.125	0.75	0.312	3	AIS-2	T15	VCGT-160412	20000

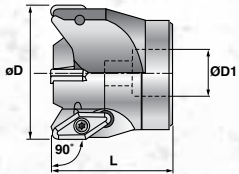

ASMN Shell Milling Cutters

Tool Ordering Number	Dimensions					Use with			RPM Max
	ØD	L	ØD1	Key Width	Z	Screw	Key	Inserts	
ASMN-2.00/3	2.00	2.125	0.75	0.312	3	AIS-2	T15	VCGT-160412	20000

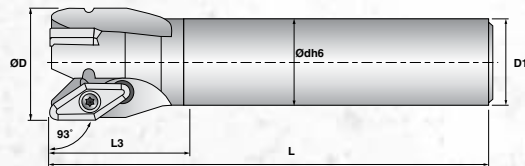

AEMC End Milling Cutters

Tool Ordering Number	Dimensions						Use with			RPM Max
	ØD	L	L1	D1	L3	Z	Screw	Key	Inserts	
AEMC-1.00/3-4	1.00	4.00	0.394	0.75	NA	3	AIS-1	T7	VCGT-110308	30000
AEMC-1.00/3-6	1.00	6.00	0.394	0.75	NA	3	AIS-1	T7	VCGT-110308	30000

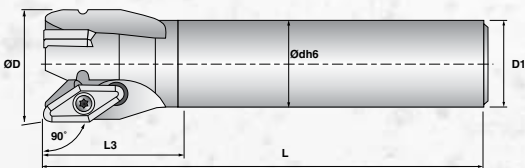

AEMN End Milling Cutters

Tool Ordering Number	Dimensions						Use with			RPM Max
	ØD	L	L1	D1	L3	Z	Screw	Key	Inserts	
AEMN-1.00/3-4	1.00	4.00	0.394	0.75	NA	3	AIS-1	T7	VCGT-110308	30000
AEMN-1.00/3-6	1.00	6.00	0.394	0.75	NA	3	AIS-1	T7	VCGT-110308	30000
AEMN-1.00/3-8	1.00	8.00	0.394	0.75	NA	3	AIS-1	T7	VCGT-110308	30000

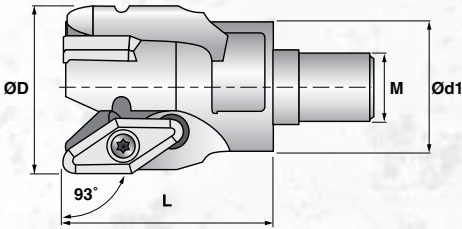

ASOC Modular Screw-On Heads

Tool Ordering Number	Dimensions (mm)					Use with			RPM Max
	ØD	L	Ød1	M	Z	Screw	Key	Inserts	
ASOC-25/3	25	50	21	M12	3	AIS-1	T7	VCGT-110308	30000
ASOC-32/3	32	50	29	M16	3	AIS-2	T15	VCGT-160412	28000
ASOC-42/3	42	50	29	M16	3	AIS-3	T20	VCGT-220530	24000

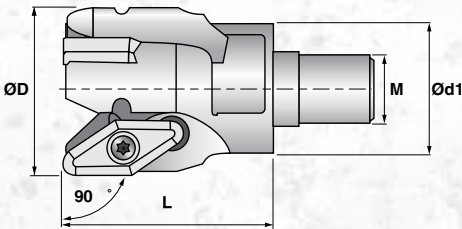

ASON Modular Screw-On Heads

Tool Ordering Number	Dimensions (mm)					Use with			RPM Max
	ØD	L	Ød1	M	Z	Screw	Key	Inserts	
ASON-25/2	25	35	18	M10	2	AIS-1	T7	VCGT-110308	30000
ASON-25/3	25	50	21	M12	3	AIS-1	T7	VCGT-110308	30000
ASON-32/3	32	50	29	M16	3	AIS-2	T15	VCGT-160412	24000
ASON-42/3	42	50	29	M16	3	AIS-3	T20	VCGT-220530	24000

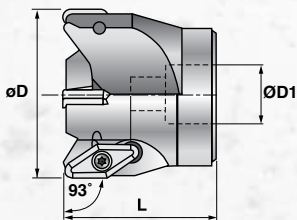

ASMC Shell Milling Cutters

Tool Ordering Number	Dimensions (mm)					Use with			RPM Max
	ØD	L	ØD1	Key Width	Z	Screw	Key	Inserts	
ASMC-50/3	50	55	22	10,4	3	AIS-2	T15	VCGT-160412	23000
ASMC-63/4	63	60	22	10,4	4	AIS-2	T15	VCGT-160412	20000
ASMC-80/4	80	60	27	12,4	4	AIS-3	T20	VCGT-220530	18000

Indexable Milling Program Tools for Aluminum Alloys

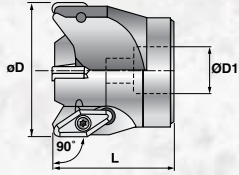

ASMN Shell Milling Cutters

Tool Ordering Number	Dimensions (mm)						Use with			RPM Max
	ØD	L	ØD1	Key Width	L2	Z	Screw	Key	Inserts	
ASMN-42/3	42	55	16	8,4	15	3	AIS-3	T20	VCGT-220530	24000
ASMN-50/3	50	55	22	10,4	13	3	AIS-2	T15	VCGT-160412	23000
ASMN-52/3	52	55	22	10,4	15	3	AIS-3	T20	VCGT-220530	22000
ASMN-63/4	63	60	22	10,4	13	4	AIS-2	T15	VCGT-160412	20000
ASMN-66/4	66	60	27	10,4	15	4	AIS-3	T20	VCGT-220530	19000
ASMN-80/5	80	60	27	12,4	15	5	AIS-3	T20	VCGT-220530	18000
ASMN-100/5	100	65	32	14,4	15	5	AIS-3	T20	VCGT-220530	16000

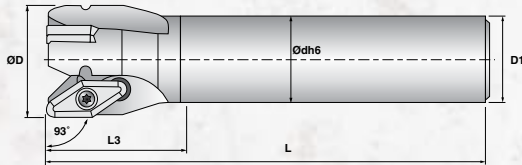

AEMC End Milling Cutters

Tool Ordering Number	Dimensions (mm)						Use with			RPM Max
	ØD	L	L1	D1	L3	Z	Screw	Key	Inserts	
AEMC-25/3	25	140	10	20	40	3	AIS-1	T7	VCGT-110308	30000
AEMC-32/3	32	140	13,5	25	50	3	AIS-2	T15	VCGT-160412	28000
AEMC-42/3	42	140	15	32	50	3	AIS-3	T20	VCGT-220530	24000

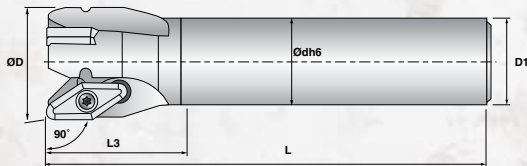

AEMN End Milling Cutters

Tool Ordering Number	Dimensions (mm)						Use with			RPM Max
	ØD	L	L1	D1	L3	Z	Screw	Key	Inserts	
AEMN-20/2-L100	20	100	10	18	30	2	AIS-1	T7	VCGT-110308	30000
AEMN-20/2-L200	20	200	10	18	30	2	AIS-1	T7	VCGT-110308	26000
AEMN-25/3-L140	25	140	10	20	40	3	AIS-1	T7	VCGT-110308	30000
AEMN-25/3-L240	25	240	10	20	40	3	AIS-1	T7	VCGT-110308	26000
AEMN-32/3-L140	32	140	13	25	50	3	AIS-2	T15	VCGT-160412	28000
AEMN-32/3-L240	32	240	13	25	50	3	AIS-2	T15	VCGT-160412	24000
AEMN-42/3-L140	42	140	15	32	50	3	AIS-3	T20	VCGT-220530	24000
AEMN-42/3-L240	42	240	15	32	50	3	AIS-3	T20	VCGT-220530	20000